

Seymour Duncan®

Congratulations on your purchase of a fine, hand-built, Seymour Duncan electric guitar pickup! Installing this pickup in your guitar isn't rocket science. And, if you're already handy with tools, it'll be a snap for you—and fun too! But if you have no experience handling red-hot soldering irons, you'd be well advised to take your new pickup and your trusty guitar to a qualified guitar tech.

Wiring Diagram for Pickup Models:

STL-1b, STR-1, STL-1, APTL-1, APTR-1, STL52-1, STR52-1, STL-2, STR-2, STL-3, STR-3, APTL-3JD

5427 hollister avenue, santa barbara, ca 93111
tel 805.964.9610 fax 805.964.9749
www.seymourduncan.com

The basic steps for Lead Pickups include:

1. Remove the strings from your guitar.
2. Remove the control plate and flip it over.
3. De-solder the original pickup's wires from the controls and make sure to remember where they were connected.
4. Remove the original pickup from the bridge.
5. Put the Seymour Duncan pickup into the bridge.
6. Tin the wires from the Seymour Duncan pickup, and then solder them into place (see Fig. 1. For tapped wiring options, see Fig. 2 and 3).
7. Re-attach the bridge to the top of the guitar.
8. Re-string your guitar and adjust the pickup height so that your new pickup is set between 1/8" and 1/16" from the strings (when they are pressed down at the highest fret on the neck). Then adjust the height of the rhythm pickup so that it balances properly with the output of the lead pickup that you just installed.

For Rhythm Pickups see reverse side

Fig. 1

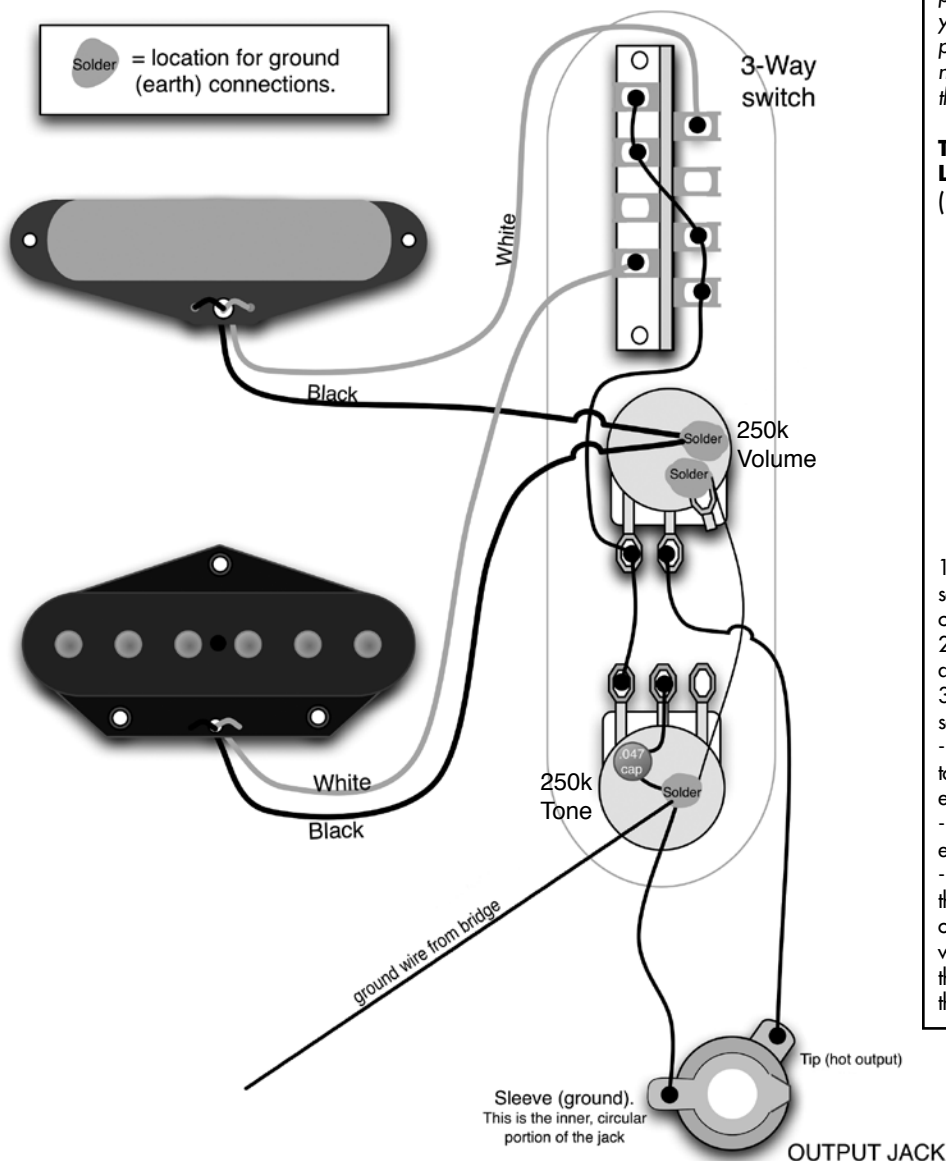

If two pickups sound thin and wimpy when used together, chances are, they're out of phase with each other. If you're combining your Seymour Duncan pickup(s) with Fender® pickup(s) in the same guitar, you'll probably need to reverse the black and white wires on the Seymour Duncan.

To Change the Phase of a Lead Pickup

(Bottom View of Tele Lead Pickup)

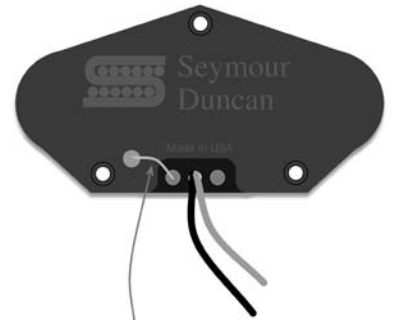

1. Cut the small **jumper-wire** that is soldered to the bottom plate (make sure the connection is broken)
2. Connect the black wire to the 3-way switch, and connect the white wire to ground.
3. Make sure the bridge is grounded with a separate wire--to do this:
 - Take a piece of wire and solder one end of it to the bottom of the volume pot. Run the other end of that wire into the lead pickup cavity.
 - Strip about one inch of insulation from the end of the wire.
 - Place the exposed end of that wire on top of the guitar's body, and screw the bridge down on top of it. (some guitars will already have this wire in place). The metal bridge will contact the wire and create a ground connection for the bridge and strings.

The basic steps for Rhythm Pickups include:

Vintage Tele® Guitars:

1. Remove the strings from your guitar.
2. Remove the control plate and flip it over.
3. Remove the pickguard and set it aside.
4. De-solder the original pickup's wires from the controls, and make sure to remember where they were connected.
5. Remove the original pickup from the body of the guitar.
6. Install your new Seymour Duncan pickup using the provided wood screws and rubber spacers.
7. Tin the wires of your new pickup and solder them into place (see Fig. 1 or 2).
8. Replace the pickguard and control plate.
9. Re-string your guitar and adjust the height of your new rhythm pickup so that its output balances with the output of your guitar's lead pickup.

Modern Tele® Guitars:

1. Remove the strings from your guitar.
2. Remove the control plate and flip it over.
3. Remove the pickguard and flip it over, taking care not to scratch your guitar's finish.
4. De-solder the original pickup's wires from the controls and make sure to remember where they were connected.
5. Remove the original pickup from the pickguard.
6. Put the Seymour Duncan pickup into the pickguard using the original mounting screws and spacers.
7. Tin the wires from your new pickup, and then solder them into place (see Fig. 1 or 2).
8. Replace the pickguard and control plate.
9. Re-string your guitar and adjust the height of your new rhythm pickup so that its output balances with the output of your guitar's lead pickup.

Fig. 2

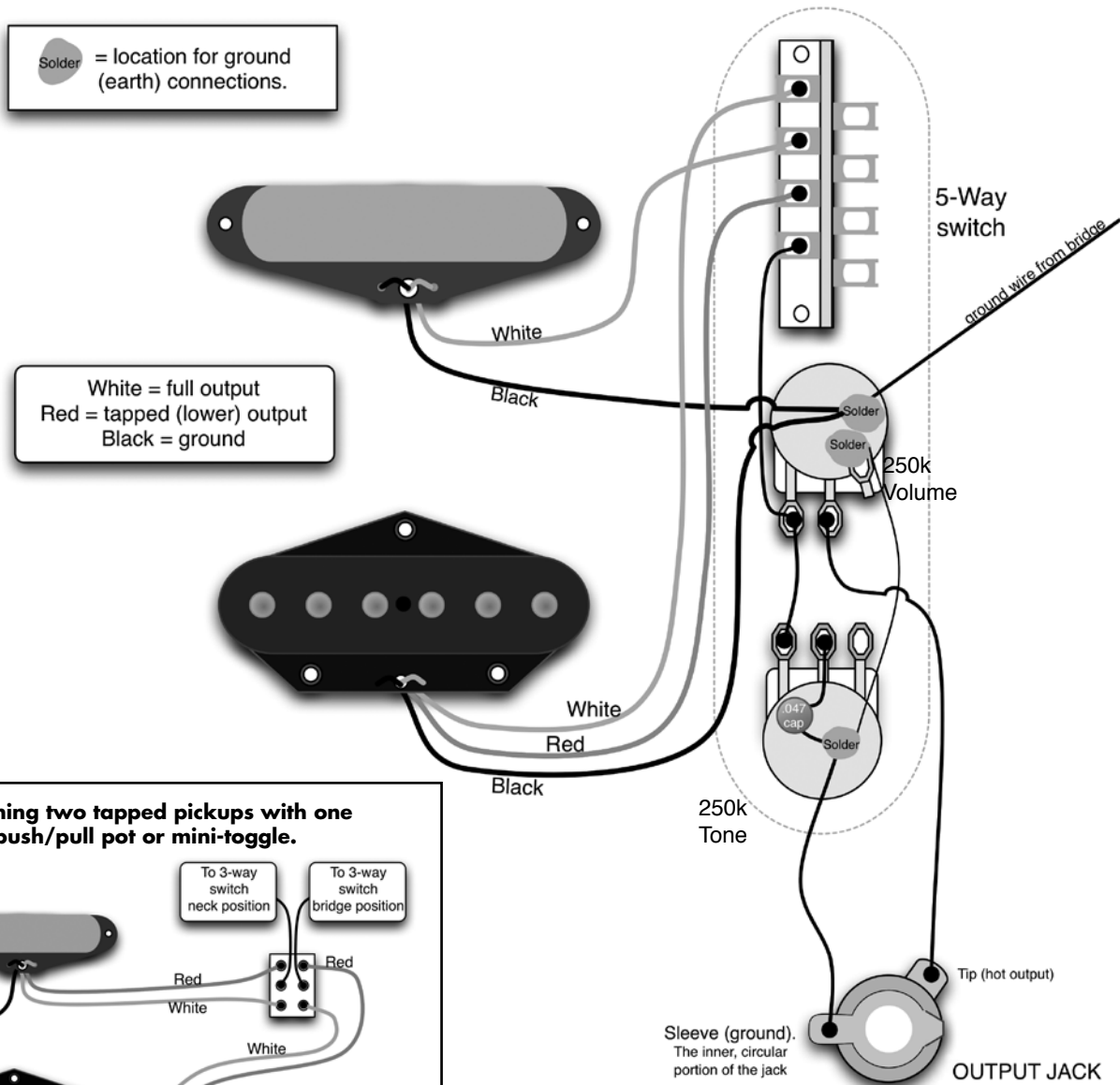
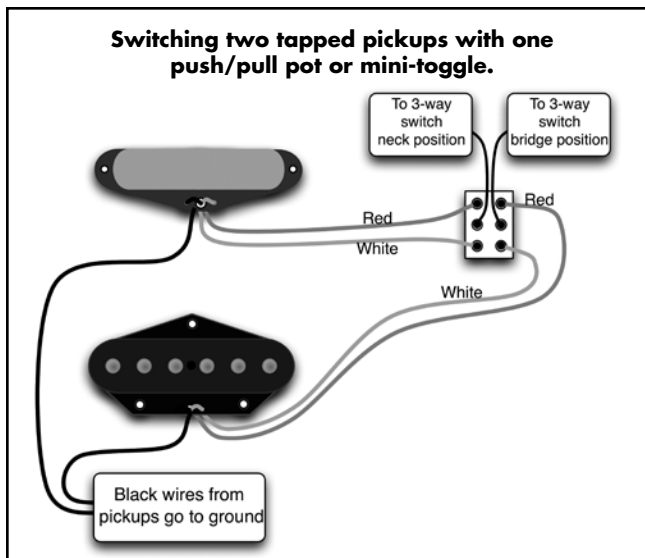

Fig. 3



Visit seymourduncan.com for additional wiring diagrams.